

■ **Outline Dimension Drawing**

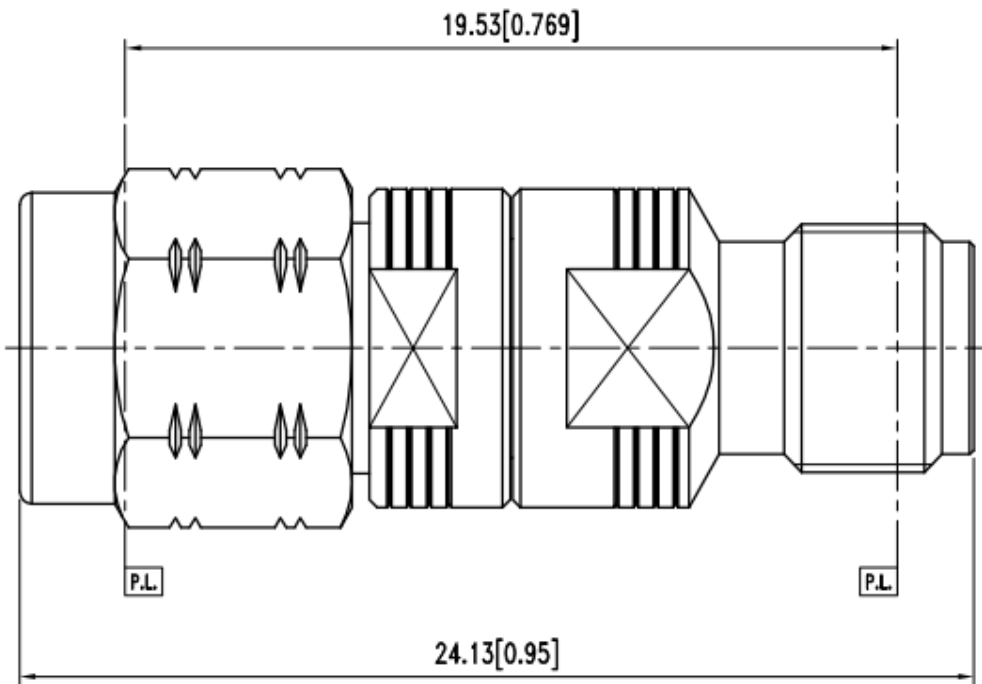

■ **Material Specification**

| Description | Material | Plating |
|--------------|----------------------|-----------------------|
| Body | SUS303 | Passivated |
| Contact | BeCu | Gold (30 microinches) |
| Dielectric | High Performance | N/A |
| | Application Material | |
| Coupling Nut | SUS303 | Passivated |



■ **Electrical Specification**

| Description | | | Description | | |
|---------------------------------|-----|-----------|--------------------------|------|-----------------|
| Impedance | 50 | Ω | | | |
| Frequency | 40 | GHz Max. | Insulation Resistance | 5000 | M Ω Min. |
| VSWR | 1.2 | Max. | Inner Contact Resistance | 6.0 | m Ω Max. |
| Insertion Loss | N/A | dB | Outer Contact Resistance | 2.0 | m Ω Max. |
| Voltage Rating | N/A | Vrms Max. | | | |
| Dielectric Withstanding Voltage | 750 | Vrms Max. | | | |

■ **Mechanical Specification**

| Description | | | Description | | |
|--------------------------|-----|--------|--------------------|-----|---------|
| Center Contact | | | Recommended Torque | 8.0 | in. lbs |
| Axial Force-Mating End | 6.0 | lbs. | | | |
| Axial Force-Opposite End | 6.0 | lbs. | | | |
| Connector Durability | 500 | cycles | | | |
| Weight | 6.4 | g | | | |

■ **Environmental Specification**

| Description | | |
|------------------|-----|--------------------|
| Temperature Min. | -40 | $^{\circ}\text{C}$ |
| Temperature Max. | 105 | $^{\circ}\text{C}$ |
| Hermetic Seal | N/A | |